

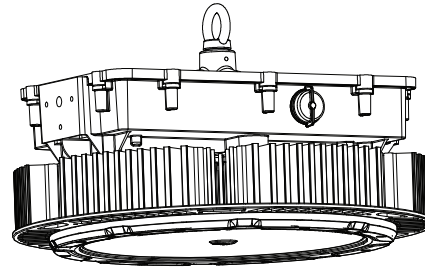

SIG-XXXW-7XX-UD
SIG-XXXW-7XX-VD



INSTALLATION INSTRUCTIONS LED SIGNAL Flood Light and High Bay

SAFETY PRECAUTIONS:

WARNING: RISK OF FIRE OR ELECTRICAL SHOCK

Consult a qualified electrician to ensure correct branch circuit conductor.

LED luminaire installation requires knowledge of luminaires electrical systems. If not qualified, do not attempt installation. Contact a qualified electrician.

To prevent wiring damage or abrasion, do not expose wiring to edges of sheet metal or other sharp objects.

Disconnect power before installing the product or servicing it.

Wait until fixture has cooled down before installing or servicing the fixture.

Mounting height of fixture should be no higher than 30m (98ft).

Do not install in narrow or enclosed areas.

For use in environments where an accumulation of non-conductive dust on the luminaire may be expected.

Terminal block not included.

The external cord of this luminaire cannot be replaced; if the cord is damaged, discard the luminaire and contact the manufacturer.

WIRING:

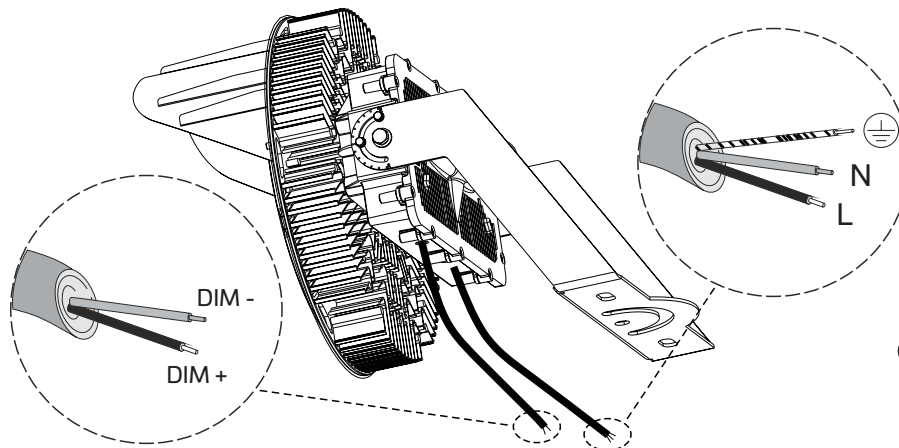

L: brown/black
N: blue/white
⊕: yellow/green

DIM +: blue/brown/purple/white
DIM -: white/blue/gray/black

Z10 DEVICE INSTALLATION:

ALWAYS TURN OFF THE POWER SUPPLY FROM MAIN CIRCUIT BREAKER FIRST!

Z10 Socket and sealing cap are installed on the side of the fixture. To install Z10 device, first turn, loosen and remove the sealing cap from the socket. Then, install and tighten Z10 device in the socket. If the Z10 device is not needed, remove the device, and install and tighten sealing cap in the socket.

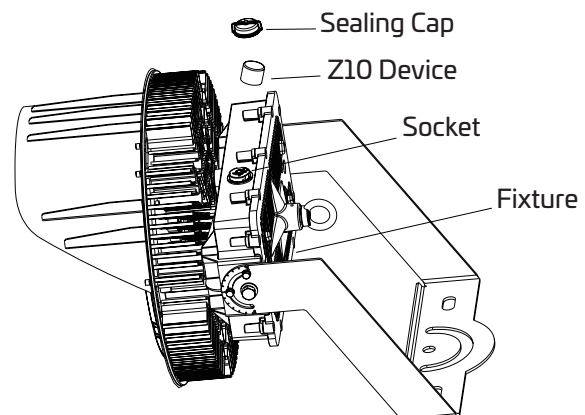

INSTALLATION INSTRUCTIONS:

A. LOOP HANGING INSTALLATION

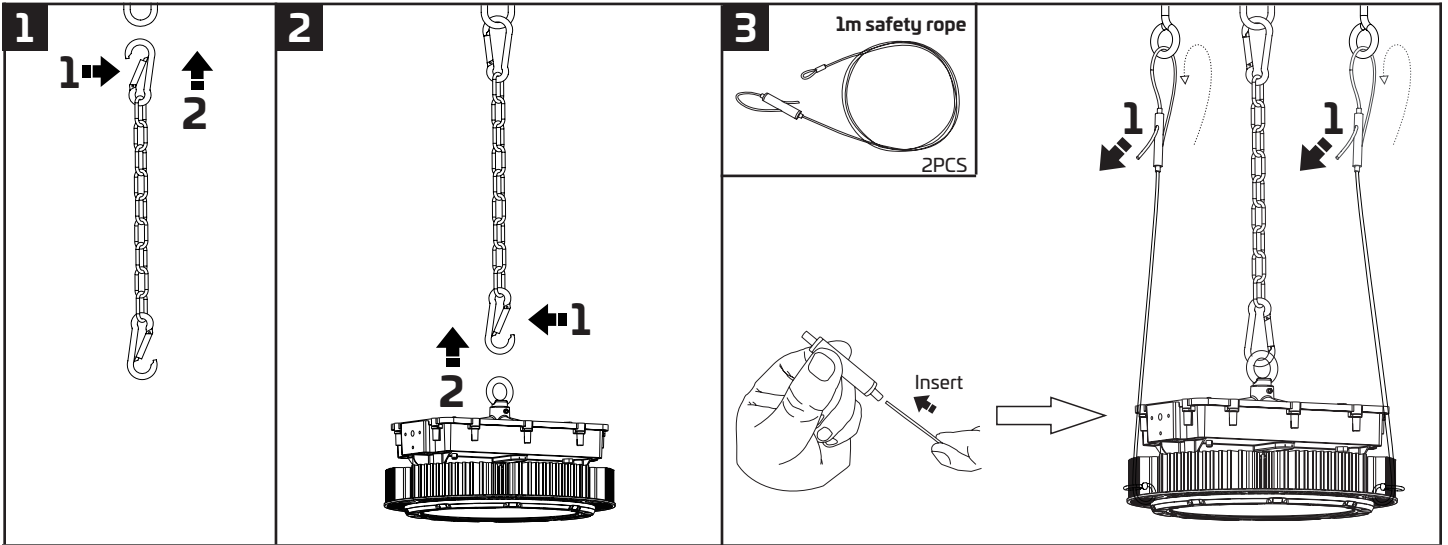

B. ROTATABLY SURFACE MOUNTING

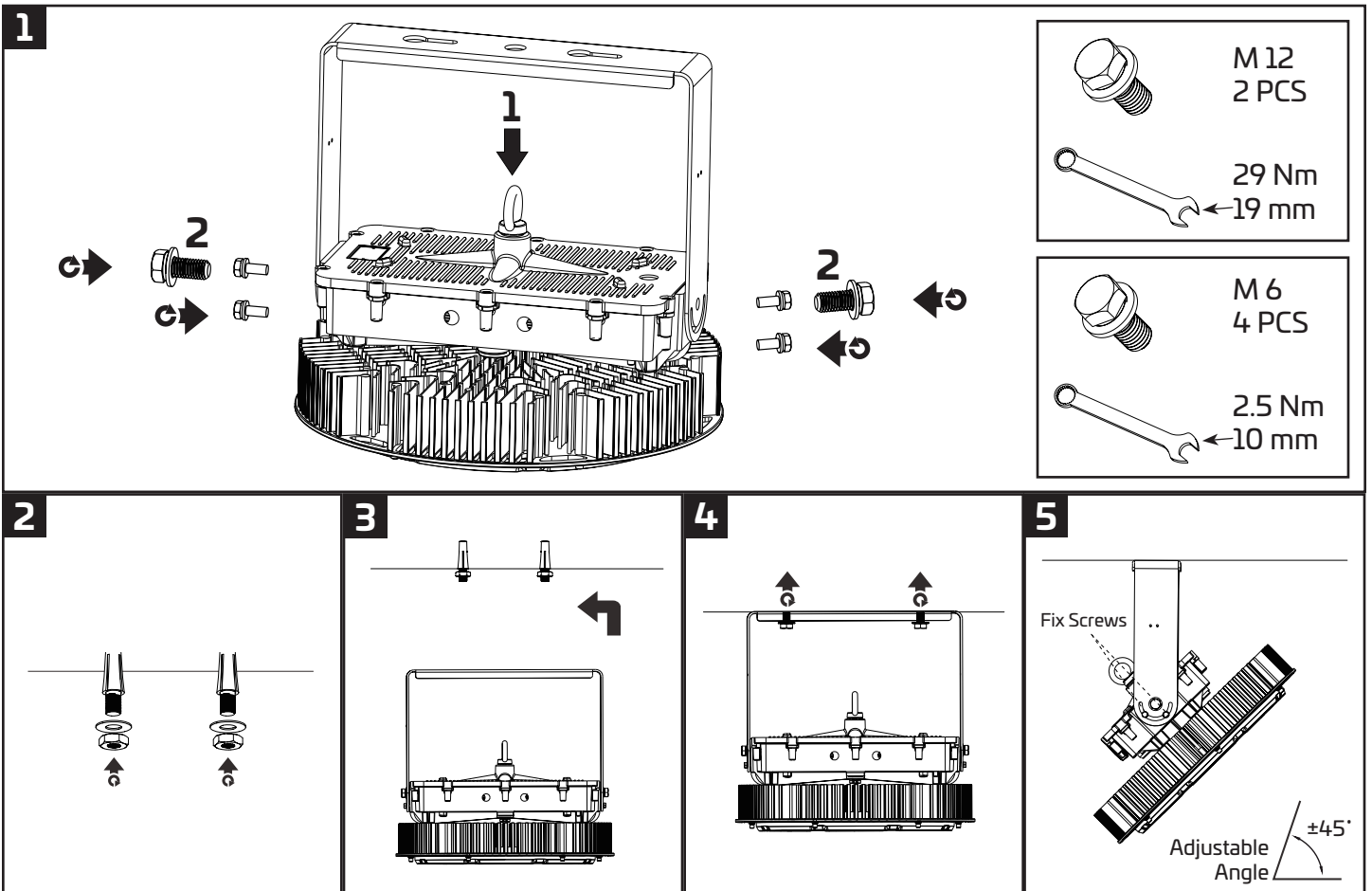

INSTALLATION INSTRUCTIONS:

C. ALU REFLECTOR INSTALLATION

1

M 5
6 PCS

2.0 Nm
4 mm

2

M 5
6 PCS

2.0 Nm
4 mm

D. SLIPFITTER MOUNTING

1

M 12
2 PCS

29 Nm
← 19 mm

M 6
4 PCS

2.5 Nm
← 10 mm

2

M 5
6 PCS

2.0 Nm
4 mm

3

Unscrew

8 Nm
← 14 mm

4

8 Nm
← 14 mm

Tighten the screws after inserting the sleeve.

5

Fix Screws

Adjustable Angle

±45°

INSTALLATION INSTRUCTIONS:

E. YOKE MOUNTING INSTALLATION

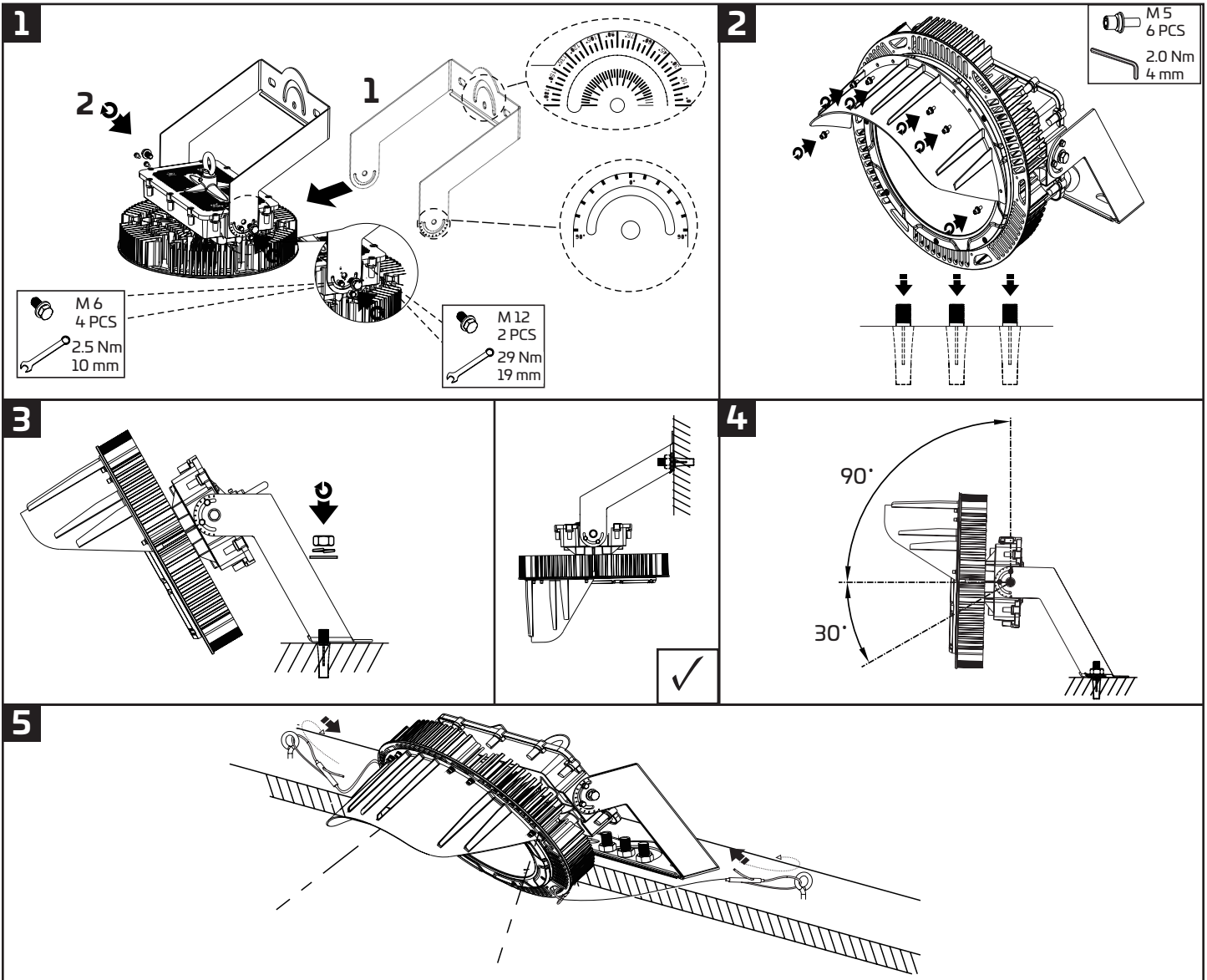

F. CHANGING FROM TEMPERED GLASS TO PC LENS

